

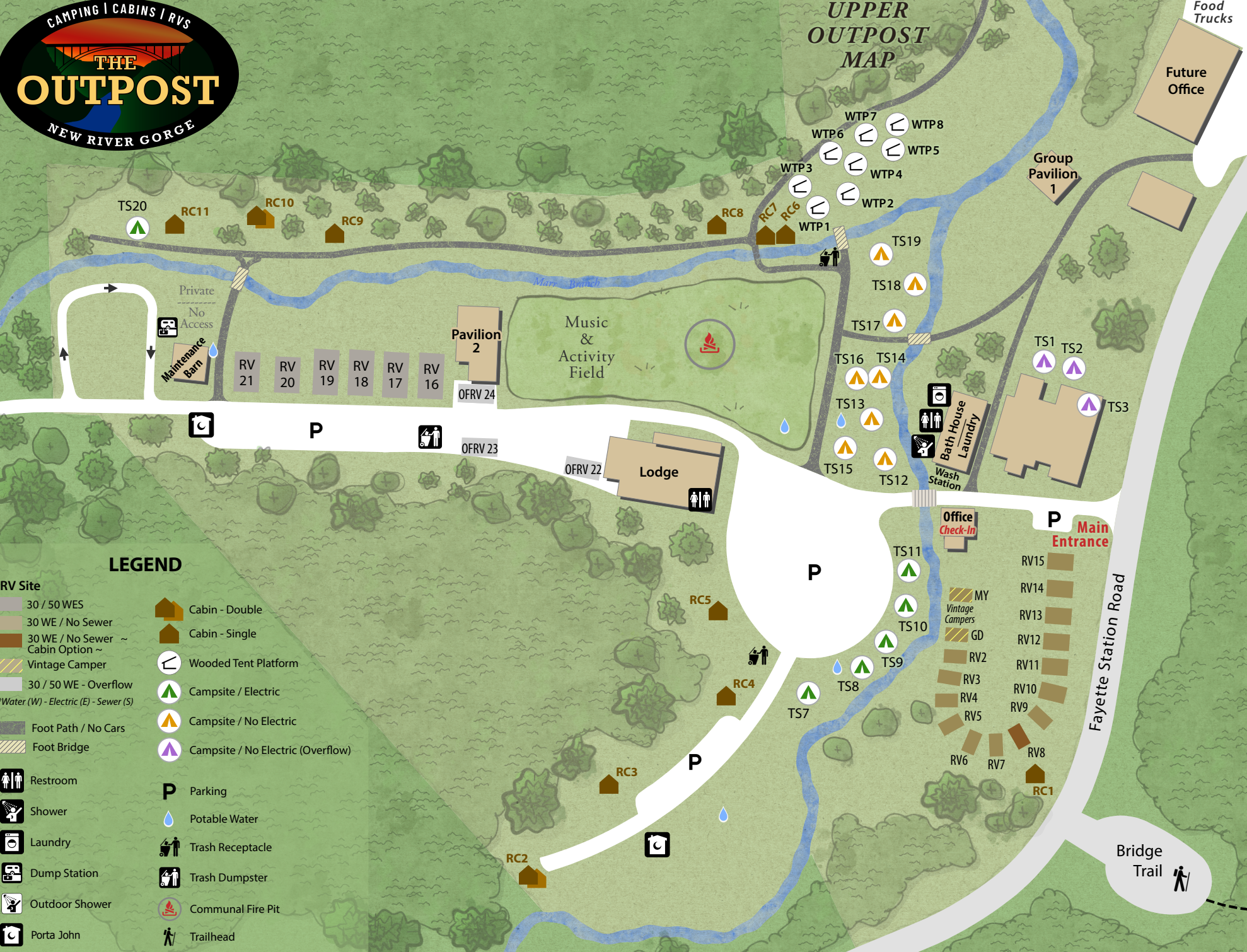

# UPPER OUTPOST MAP



## LEGEND

- RV Site**
- 30 / 50 WES
- 30 WE / No Sewer
- 30 WE / No Sewer ~ Cabin Option ~
- Vintage Camper
- 30 / 50 WE - Overflow
- \*Water (W) - Electric (E) - Sewer (S)*
- Foot Path / No Cars
- Foot Bridge
- Restroom
- Shower
- Laundry
- Dump Station
- Outdoor Shower
- Porta John
- Cabin - Double
- Cabin - Single
- Wooded Tent Platform
- Campsite / Electric
- Campsite / No Electric
- Campsite / No Electric (Overflow)
- Parking
- Potable Water
- Trash Receptacle
- Trash Dumpster
- Communal Fire Pit
- Trailhead

Fayette Station Road

Bridge Trail

Group Pavilion 1

Music & Activity Field

Lodge

Pavilion 2

Bath House Laundry

Wash Station

Office Check-In

Main Entrance

Future Office

Food Trucks

TS20

RC11

RC10

RC9

RC8

RC7

RC6

WTP1

WTP2

WTP3

WTP4

WTP5

WTP6

WTP7

WTP8

TS19

TS18

TS17

TS16

TS15

TS14

TS13

TS12

TS1

TS2

TS3

TS11

TS10

TS9

TS8

TS7

RV15

RV14

RV13

RV12

RV11

RV10

RV9

RV8

RV7

RV6

RV5

RV4

RV3

RV2

MY

GD

Private No Access

Maintenance Barn

RV 21

RV 20

RV 19

RV 18

RV 17

RV 16

OFRV 24

OFRV 23

OFRV 22

RC2

RC3

RC4

RC5

P

P

P

P

P

P

# LOWER OUTPOST MAP

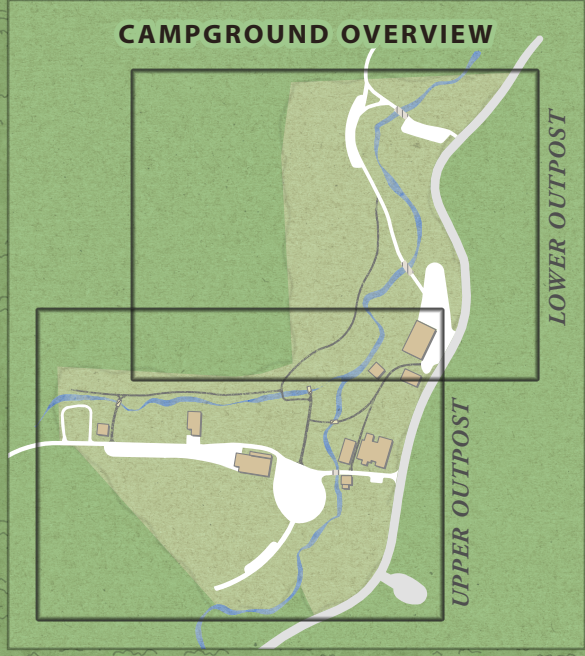

### LEGEND

**Facilities and Landmarks:**

- Entrance:** Located at the bottom right, near Fayette Station Road.
- Exit Only:** Located at the top right, near Fayette Station Road.
- Future Office:** A large brown building near the entrance.
- Group Pavilion 1:** A brown building near the bottom center.
- Food Trucks:** Located near the entrance.
- Day Parking:** A designated parking area near the entrance.
- Field Tent Camping:** A designated area with a fire pit icon near the top center.
- Wash Station:** Located near the top center, with a water tap icon.
- Campsites (TS21-TS37):** Marked with orange triangles along the riverbank.
- Tent Platforms (WTP2-WTP8):** Marked with white circles with black outlines near the bottom center.
- Power Station:** Located near the top center.
- Restroom:** Located near the top center.
- Shower - Outdoor:** Located near the top center.
- Trash Receptacle:** Located near the top center.
- Trash Dumpster:** Located near the top center.
- Porta John:** Located near the top center.
- Wooded Tent Platform:** Located near the top center.

**Other Features:**

- Fayette Station Road:** A road running along the right side of the river.
- ONE WAY:** A sign indicating traffic flow on Fayette Station Road.
- Parking (P):** Designated parking areas along the road.
- Private Property / No Access:** Located at the top of the map.